

PLANS OF THE EXHIBITION BUILDINGS.

These plans are not published as official, but are complete and correct up to the hour of going to press (Thursday noon). They will be revised and corrected from day to day and published in the daily edition of PROGRESS as a guide to exhibitors and visitors.

The Daily Edition of PROGRESS will be published every afternoon and evening in the Exhibition Buildings (Machinery Hall) while the Exhibition is open. Subscribers, Advertisers, and all who want to see us can call on us there.

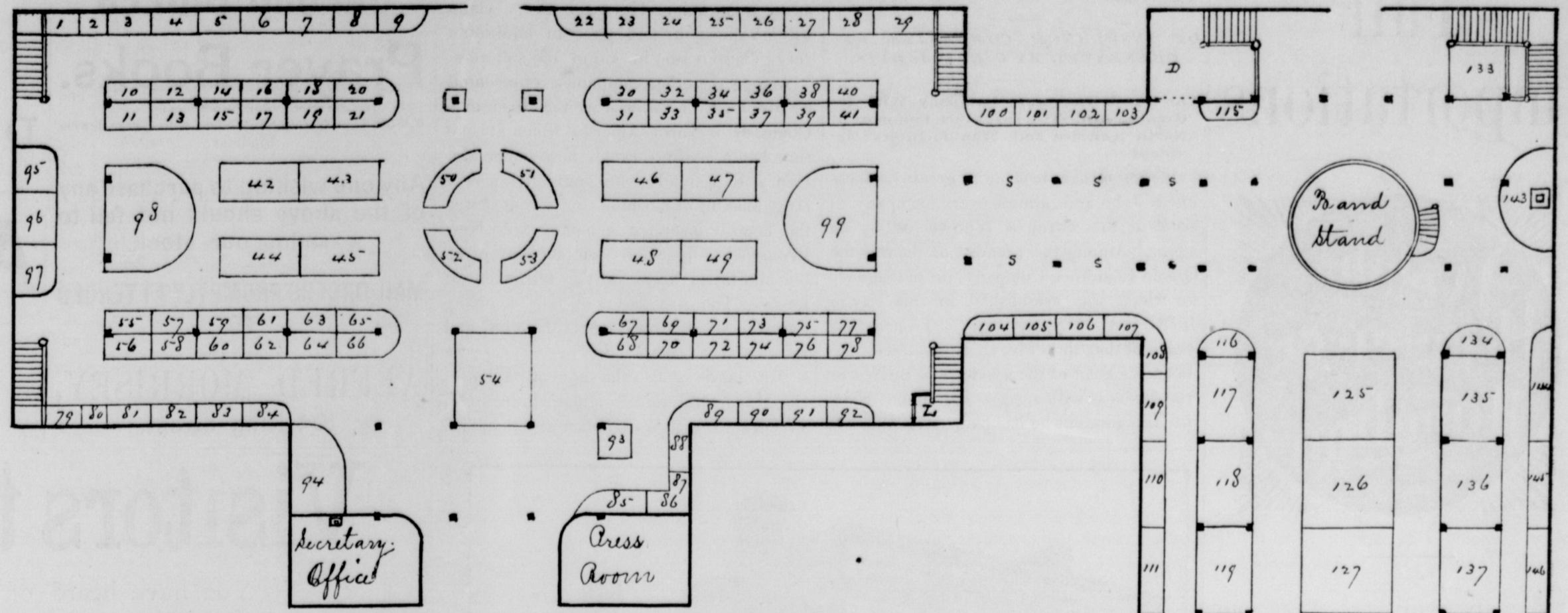

PRINCIPAL FLOOR.

- 1, 9—Field roots, etc.
- 10, 15—Grain and garden vegetables.
- 16, 17—Exhibit of government experimental farm, Nappan, N. S.
- 22, 23—Dairy exhibits butter.
- 30, 32, 34, 35, 38, 40—Dairy exhibits cheese.
- 31, 33, 35, 37, 39, 41—Cut flowers.
- 42, 45—Fruit.
- 46, 49—Flowers and plants in pots.
- 50, 54—West India exhibits.
- 55, 66—British Columbia exhibits.
- 67, 78—Manitoba.
- 79, 84—Vegetables.
- 85, 88—Bell Cigar Co., special privilege, manufacturing cigars.
- 89, 92, 94—Ganong Bros., special privilege for manufacture and sale confectionery.
- 95, 96 and 97—W. Bell & Co., pianos and organs.
- 98—Evans Piano Company, pianos and organs.
- 99—Karr Organ Company, pianos and organs.
- 100, 101, 102—W. A. Erb, mower and thrasher repairs.
- 103—T. S. Simms & Co., brooms and brushes.
- 104—Joseph Dalzell, fishing rods.
- 105—Geo. A. Davis, patent umbrella stand.
- 107—All represented by W. H. Thorne & Co.—107.

- 108—E. Inburo Roprice Company, Glasgow, cordage; 108, Wm. Hansell & Co., Bridport, England, twines and lines; 109, T. Brown & Co., nets and twines; 110, Henderson & Potts, Halifax, N. S., paints and colors; 117, W. Carson & Sons, London, England, paint and colors; Peterboro Lock Company, Peterboro, Ont., locks, etc.; Neverslip Horse Shoe Company; Canada Horse Nail Company, mill, circular and cross cut saws.
- 112, A—C. N. Vroom, drain pipe.
- 112 B, 113 A—J. A. Whelpley, skates and iron toys.
- 113, B—McCaw, Stevenson & Orr, Ireland, window transparencies, represented by F. E. Holman.
- 114—E. Broad & Son, tools and handles.
- 115, 117—W. H. Thorne & Co.
- 118—C. E. Reynolds, furniture.
- 119, A—L. B. Robertson, show cases, rubber stamps, typewriters, etc.
- 119, B—Acadia Pottery Company, pottery.
- 120, A—E. V. Wetmore, stair building material.
- 120, B—John Sime, doors, sashes, etc.
- 120, B—Thomas Ellis, sash balance.
- 121, A—Nevis & Haviland, New York, represented by F. E. Holman.
- 121, B—F. E. Holman, window shades.
- 121, B—J. W. Ramsdell, St. John.

- 122—Henderson & Co., Durham, Eng., carpets, curtain poles and cornices, etc., represented by A. O. Skinner.
- 123—Miss Whitney, Hand-painted china.
- 125, 126 A—John White, furniture.
- 126, B, 127, A—Hutchings & Co., mattresses, etc.
- 129, 130, A—A. J. Lordly & Sons, furniture.
- 130, A 131—R. S. Williams & Sons, pianos.
- 134, 135—T. McArdy & Sons, brass fittings, etc.
- 135, A—Walter, Wilson, saws.
- 136, A—Keenan & Hatchford, tin and copper ware.
- 136, B—Burrill & Johnson Iron Company, stoves and ranges.
- 137, A—Pool & Foley, earthenware and pipes.
- 137, B—Adam Young, ranges.
- 138, A 139, A—Emerson & Fisher, slate mantles.
- 138 B, 139 B—Enterprise Foundry Company.
- 140, A—James Robertson, saws, paints, etc.
- 140, B 141—J. & J. Taylor, safes.
- 143—Frank McMillan, plaster work.
- 144—T. McArdy & Sons, brass fittings, bells, etc.
- 145, 146, 147, 148, A—Novelties and inventions.
- 148, B—Bradley Bros., pulleys, blocks, etc.
- 149, A—G. F. Thompson & Son, paints.
- 149, B—W. Harper, files.
- 149, C—J. Fowler, springs, axles and edge tools.
- 142—J. O. Miller, light refreshments.

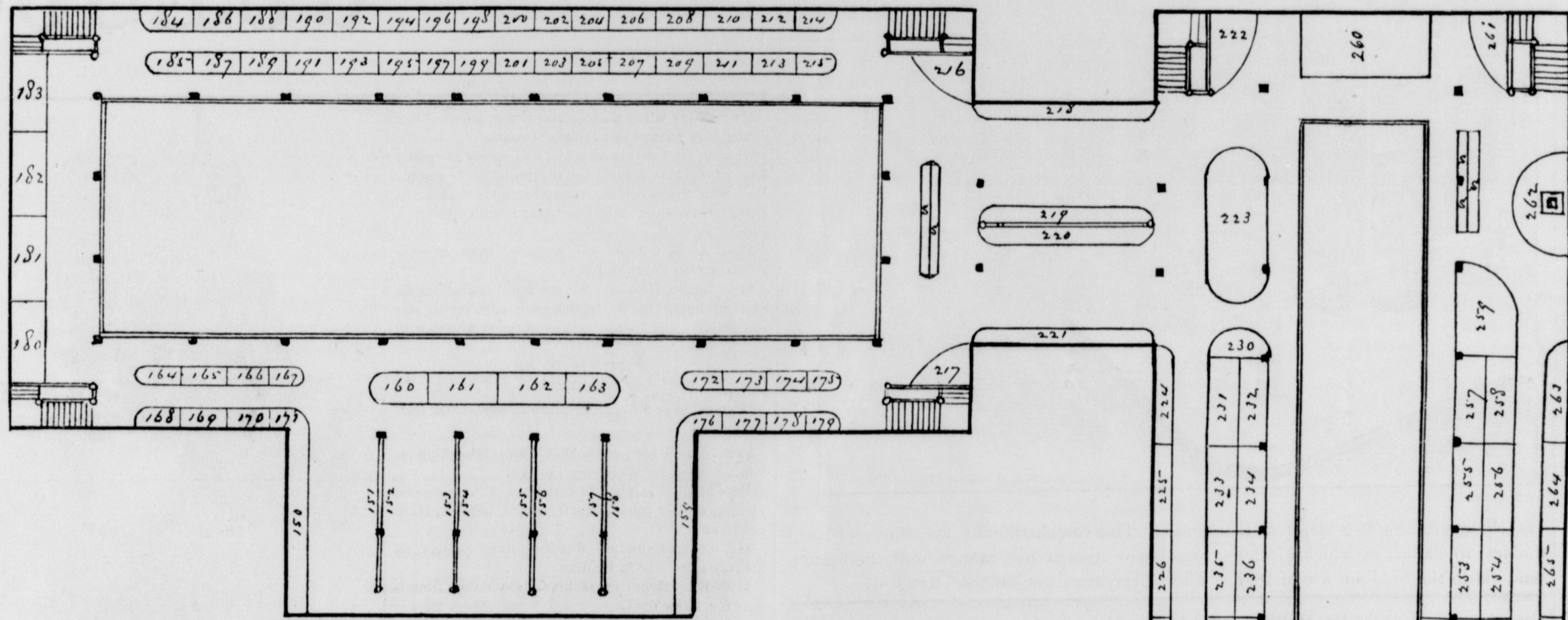

GALLERY.

- 150 B, 171—J. & A. McMillan, blank books, etc.
- 151 to 158—Educational exhibits.
- 159 to 183—Ladies' needle work and fancy goods department.
- 186 to 203—Thomas Organ Co., organs.
- 205, 207—Wm. Logan, laundry soap.
- 209, 211—S. C. McNutt, soap.
- 213 to 215—St. Croix Soap Co., soap.
- 216—St. Croix Soap Co., special privilege.
- 222—Kerr Vegetable Evap. Co., Vegetable Soups, and Spa Springs Mineral Water Co., special privileges.
- 223—Dominion Organ Co., pianos and organs.
- 224 A—Chas. K. Short, pharma. preparations.
- 224 B—Wm. B. McVey, pharma. preparations.
- 224 C—E. M. Estey, pharma. preparations.
- 224 D—F. H. Frost, inks, shoe dressing, etc.
- 225 A—McLeod Manufacturing Co., fruit syrups and proprietary articles.
- 225 B—C. H. Pendleton, prop. medicine.
- 225 C—E. H. Lester, dinner pills.
- 225 D—J. R. Smith, mineral water.
- 226 A—E. T. Coram, silver polish.

- 226 B—T. W. Paul, stove polish.
- 226 C—Letteney Manufacturing Co., stove polish.
- 227 A—E. W. B. Snider, flour.
- 227 B—David Clark, flour.
- 227 C—W. H. Helme, pickles.
- 228 A—T. McCready & Sons, vinegar.
- 228 B, 229 A—Dearborn & Co., spices, etc.
- 229 B—A. P. Tippet & Co., canned finnan haddies.
- 229 C—W. Laaf, preserves.
- 230—Ganong Bros., confectionery and syrups.
- 231—Brown & Leetch, paper boxes and bags.
- 232—Kilgour Bros., paper and paper bags.
- 233, 234—Imperial Oil Co., petroleum products.
- 235 A—James Patterson, dry and smoked fish.
- 235 B—Boutelier & Morehouse, canned finnan haddies.
- 235 C—F. F. Dalley & Co., stove polish.
- 236 A—Truro Condensed Milk Co., condensed milk.
- 236 B—John Windsor, canned fish and fruits.
- 237 A—Oriental Flour Co., corn flour.
- 237, B—Bryden Bros. & Co., biscuits.
- 238—Delhi Canning Co., canned goods, jellies, etc.
- 239—N. B. Paper & Box Co., paper boxes and bags.
- 240—Hollingsworth & Whiting, paper and bags.

- 241, A—J. L. Barrie & Co., wines.
- 241, B—Ontario vine growers and wine makers association wines.
- 242, A—P. N. O'Mullin, bottled ale and porter.
- 242, B—A. McDougall, liquors.
- 243—J. R. Woodburn & Co., confectionery.
- 244, 245—C. Flood & Sons, pianos, etc.
- 246—Christy & Co., hats and caps.
- 247, 248—C. & E. Everett, hats, caps, furs.
- 249, 250—D. Magee's Sons, hats, caps, furs.
- 251, 252—Manks & Co., hats, caps, furs.
- 253, 254—Tryon Woolen Mills, tweeds, etc.
- 255—W. Parks & Son, cotton goods.
- 256—C. H. Peters, leather.
- 257, 258, 259—J. W. Simmons, Leather.
- 263 A—Jas. D. Smith, trunks.
- 263 B—C. N. Vroom, laragins, etc.
- 263 C—James Patterson, oil clothing.
- 265—J. M. Humphrey, rubber and oil clothing, boots and shoes.
- 266—Sequin & Laline, boots and shoes.
- 267 A—J. S. Pollerin, boots and shoes.
- 267 B, 268 A—Archibald & Turner, boots and shoes.

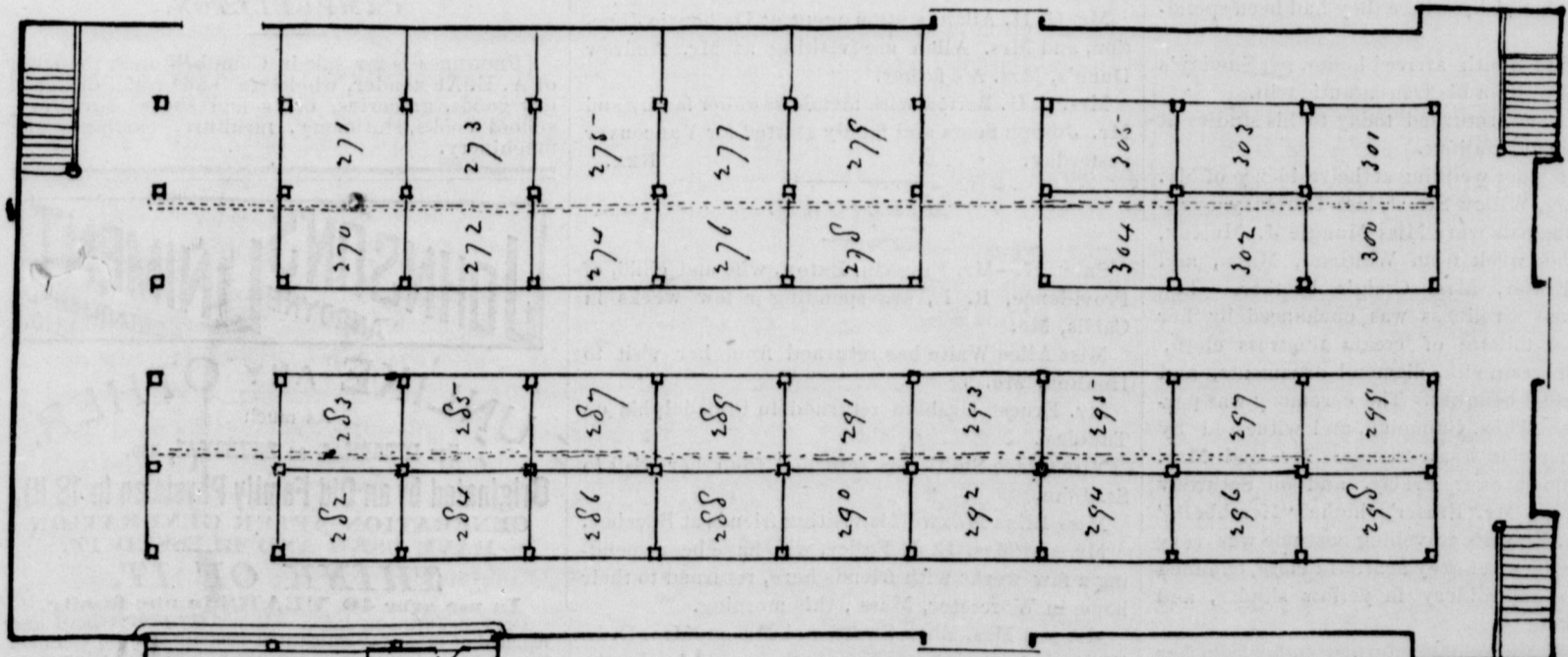

MACHINERY HALL.

- 270, A—T. McArdy & Sons, pump, etc., inspirators, etc.
- 270 and 271—Goldie & McCullough, wood working machinery.
- 272, A—J. M. Ruddock, small yacht, engine, shaft and propeller.
- 273—50 h. p. G. & McC. Wheelock automatic engine, driving shafting in machinery hall.
- 274—Dynamas, furnishing light.
- 275—E. Leonard & Sons, two Leonard-Ball engines, 40 and 75 h. p.
- 283—G. M. Cossitt & Bro. " "
- 284, 285—A Harris, Son & Co. " "
- 286, 287, 288, 289—"Progress" Newspaper Office, Cranston printing press.
- 290, 301—Patterson Bros, Agricultural machinery.

- 276 and 277—McGregor, Gourlie & Co., represented by J. M. Evans, wood working machinery.
- 278 and 279—T. S. Simms & Co., broom making. Spaces at East End, not numbered—J. R. Woodburn & Co., Pulverizing machines. Evans Bell, Shifting devices, &c. Myers, Pumps, shafting, hangers, pulleys, &c. Burrill & Johnson Iron Co., Steam pumps.
- 282, 284—John Bertram & Sons.
- 283—Goldie & McCullough.
- 285—Cowan & Co.
- 286, A—J. A. Whelpley.
- 302 A, 303 A—J. O. Wisner, Son & Co., Agricultural machinery.
- 304, 305—Massey Mfg Co., Agricultural machinery.

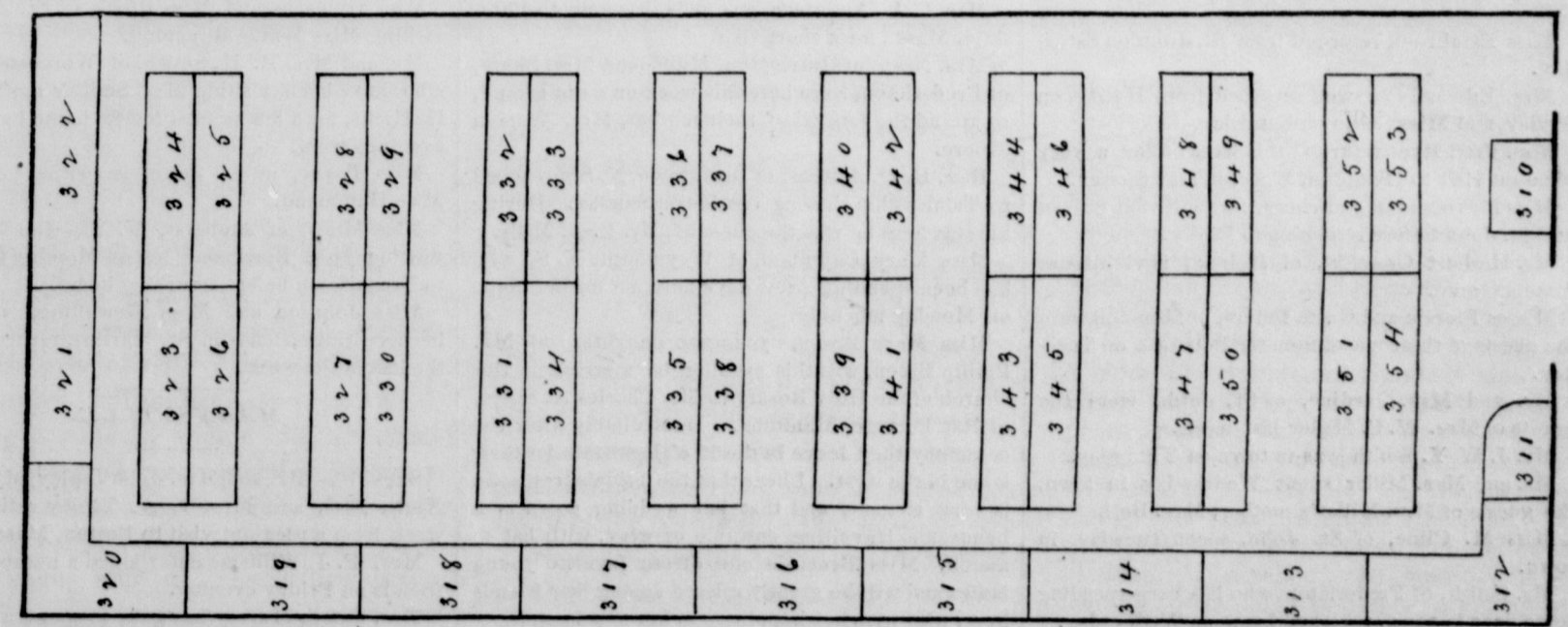

CARRIAGE BUILDING.

- 323, 324, 325, 326—Gananogue Carriage Co., Carriages.
- 327, 328—Jos. Lowrie, Carriages.
- 329, 330, 332—Wm. Ramsay, Carriages.
- 331, 333, 334—McLaughlin Carriage Co., Carriages.
- 335, 336—John Campbell, Carriages.

- 338 A—A. Berry, one Sleigh.
- 338 B—H. Parkman, one Waggon.
- 339, 340—James Masson, Carriages.
- 341, 342—Kelly & Murphy, Carriages.
- 343, 344—Price & Shaw, Carriages.
- 345, 346—Crothers, Henderson & Wilson, Carriage.

- 347, 348—J. R. Cooper, Carriages.
- 350—J. M. DeWolfe, Carriages.
- 349, 351, 352, 353, 354—Edgecombe & Sons, Carriages.
- 311, 312, 313, 314—J. B. Armstrong Mfg Co., Carriage Gears, Spring Axles, etc.
- 318, 319—Jas. Warnock, Carriage Springs, etc.